



Master II Series (1P/1P)-Rack/Tower

PRO800-QRS/QRL SERIES | 1~10kVA, p.f 1.0



CCTV & Security Systems



Local Area Network (LAN)



Work-Stations



Servers



Emergency Alarm Devices



19" Rack Mount

Prolink **Master II Series (1P/1P) Rack / Tower Type** is a new UPS series with output power factor 1.0. The system design is based on a true online double-conversion technology to optimize system reliability and to deliver clean and high quality electrical power to wide range of critical applications. High input power factor correction in the system improves the efficiency and reduces overall losses.

DSP control technology is implemented for the UPS ratings 6KVA and above to improve performance and real time harmonic cancellation. UPS is also equipped with 3-stage smart charging design to optimize battery performance. This feature extends the useful service life of battery and optimizes battery recharge time. Hot swappable battery design is implemented for the UPS ratings from 1KVA to 3KVA.

The front panel LCD display comes with rotation feature which to be used for both rack and tower types. The UPS systems have USB and RS-232 communication ports as standard, with a built-in intelligent slot for additional adapters, protocol converters and relay contact cards. SNMP option is also available for power management via SNMP manager and web browser.

PROLiNK Master II series (1P/1P) Rack / Tower- p.f.1.0 Type is available in capacities ranging from 1KVA to 10KVA. Higher charging current is available for 1KVA~3KVA models and it can be set via LCD display.

In addition, Emergency Power Off (EPO) function is also available for the UPS models and which is used to protect the personnel and the equipment in case of fire outbreak or other types of emergency.

Key Features

- True double-conversion
- DSP technology guarantees high performance
- Output power factor 1
- Wide input voltage range (110-300 VAC)
- Active input power factor correction 0.99
- 50Hz/60Hz frequency converter mode
- Programmable power management outlets[^]
- Hot swappable battery design[^]
- ECO mode energy saving
- Emergency power off function (EPO)
- Generator compatible
- Adjustable battery numbers
- Optional N+X parallel redundancy
- Adjustable charging current via LCD panel
- Smart battery charger design to optimize battery performance
- Optional Isolation Transformer Pack for 6kVA and 10kVA

[^]Only available for 1-3KVA

Rear Panel

1-3KVA

- | | |
|-----------------------------------------------------------|-------------------------------------------------|
| 1. Programmable outlets: connect to non-critical loads. | 6. RS-232 communication port |
| 2. Output receptacles: connect to mission-critical loads. | 7. Intelligent slot |
| 3. AC input | 8. Emergency power off function connector (EPO) |
| 4. Network/Fax/Modem surge protection | 9. External battery connection |
| 5. USB communication port | 10. Cooling fan |

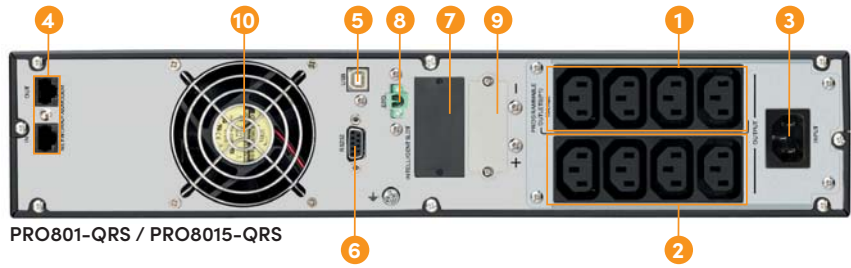

PRO801-QRS / PRO8015-QRS

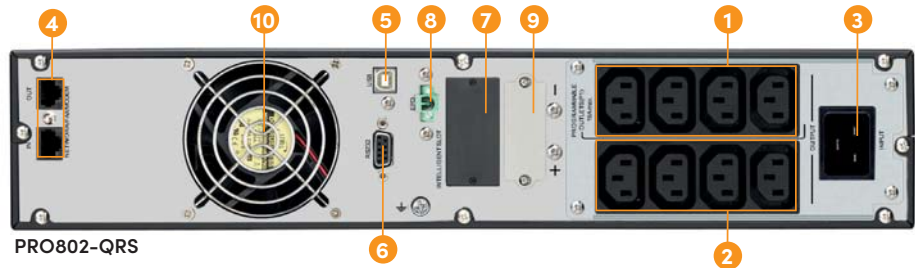

PRO802-QRS

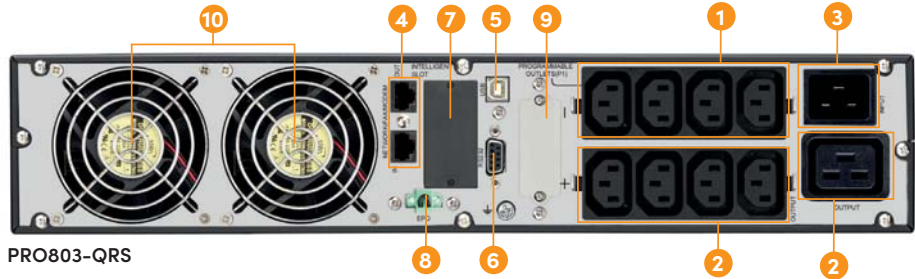

PRO803-QRS

6-10KVA

- | | |
|-------------------------------------------------------------------|---------------------------------------------|
| 1. Share current port (only available for parallel configuration) | 8. Input circuit breaker |
| 2. Parallel port (only available for parallel configuration) | 9. Output terminals |
| 3. External battery connector | 10. Ground |
| 4. Intelligent slot | 11. Input terminals |
| 5. RS-232 communication port | 12. Cooling Fan |
| 6. USB communication port | 13. External maintenance bypass switch port |
| 7. Emergency power off function connector (EPO connector) | |

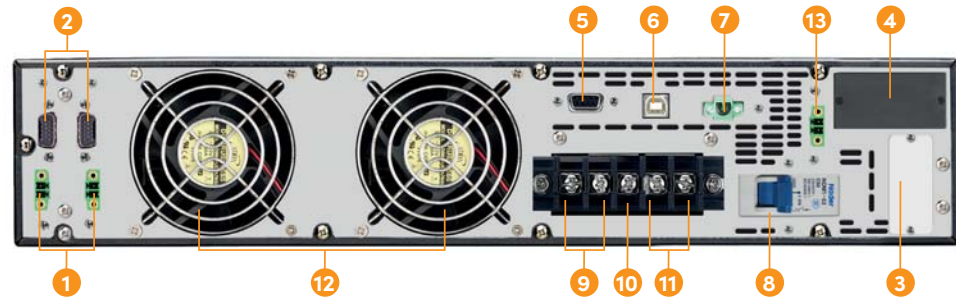

PRO806-QRS/QRL
PRO810-QRS/QRL



Specifications

MODEL	PRO801-QRS	PRO8015-QRS	PRO802-QRS	PRO803-QRS
PHASE	Single phase with ground			
CAPACITY*	1000 VA / 1000 W	1500 VA / 1500 W	2000 VA / 2000 W	3000 VA / 3000 W
INPUT				
Nominal Voltage	200/208/220/230/240 VAC			
Voltage Range	110-300 VAC \pm 5% @ 50% load 160-300 VAC \pm 5% @ 100% load			
Frequency Range	40 Hz ~ 70 Hz			
Power Factor	\geq 0.99 @ nominal voltage (100% load)			
Harmonic Distortion(THDI)	\leq 5% @ nominal input voltage			
OUTPUT				
Output Voltage	200*/208*/220/230/240 VAC			
AC Voltage Regulation (Batt. Mode)	\pm 1%			
Frequency Range (Synchronized Range)	57 ~ 63 Hz or 47 ~ 53 Hz			
Frequency Range (Batt. Mode)	60Hz \pm 0.1Hz or 50 Hz \pm 0.1Hz			
Current Crest Ratio	3:1 (max.)			
Harmonic Distortion	\leq 2 % THD (Linear Load) ; \leq 4 % THD (Non-linear Load)			
Transfer Time	AC Mode to Batt. Mode	Zero		
	Inverter to Bypass	4 ms (Typical)		
Waveform (Batt. Mode)	Pure Sinewave			
EFFICIENCY				
AC Mode	\geq 89% @ full charged battery		\geq 91% @ full charged battery	
ECO Mode	\geq 96% @ full charged battery			
Battery Mode	\geq 88%		\geq 90%	
BATTERY				
Battery Type	12 V / 7 Ah	12 V / 9 Ah	12 V / 7 Ah	12 V / 9 Ah
Numbers	3		6	
Typical Recharge Time	3 hours recover to 95% capacity for internal battery@ 2A charging current			
Charging Current	200/208/220/230/240 VAC models: default 2A, max. 12A adjustable		Default: 2A, Max: 8A adjustable	
Charging Voltage	41.1 VDC \pm 1%	41.1 VDC \pm 1%	82.1 VDC \pm 1%	82.1 VDC \pm 1%
INDICATORS				
LCD Display	UPS status, Load level, Battery level, Input/Output voltage, Discharge timer, and Fault conditions			
ALARM				
Battery Mode	Sounding every 5 seconds			
Low Battery	Sounding every 2 seconds			
Overload	Sounding every second			
Fault	Continuously sounding			
PHYSICAL				
Dimension, D x W x H(mm)	410 x 438 x 88	410 x 438 x 88	630 x 438 x 88	630 x 438 x 88
Net Weight (without battery) (kgs)	7.8	8.1	10.6	12.4
Net Weight (w/built-in battery) (kgs)	14.1	15.5	23.3	27.5
ENVIRONMENT				
Humidity	20-90 % RH @ 0- 40°C (non-condensing)			
Noise Level	Less than 50dB @ 1 Meter			
MANAGEMENT				
Smart RS-232/USB	Supports Windows® 2000/2003/XP/Vista/2008/7/8/10, Linux and MAC			
Optional SNMP	Power management from SNMP manager and web browser			
COMPLIANCE STANDARDS				
Safety	IEC/EN 62040-1			
EMC	IEC/EN 62040-2			
Performance	IEC/EN 62040-3			

*Derate capacity to 80% when the output voltage is adjusted to 200VAC/208VAC.
Product specifications are subject to change without further notice.
100/110/115/120/127VAC input and output is available as an option for 1~3KVA

Specifications

MODEL		PRO806-QRS/QRL	PRO810-QRS/QRL
PHASE		1 phase in / 1 phase out	
CAPACITY*		6000 VA / 6000 W	10000 VA / 10000 W
INPUT			
Nominal Voltage		208/220/230/240 VAC	
Voltage Range		110~300VAC ± 3% at 50% load 176~300VAC ± 3% at 100% load	
Frequency Range		46~54 Hz Ⓞ 50Hz / 56~64 Hz Ⓞ 60Hz	
Power Factor		≥ 0.99 @ full load	
THDi		< 4% @100% Load, < 6% @50% Load	
OUTPUT			
Output Voltage		208*/220/230/240 VAC	208*/220/230/240 VAC
AC Voltage Regulation		± 1%	
Frequency Range (Synchronized Range)		46~54 Hz Ⓞ 50Hz / 56~64 Hz Ⓞ 60Hz	
Frequency Range (Batt. Mode)		50 Hz ± 0.1 Hz or 60 Hz ± 0.1 Hz	
Current Crest Ratio		3:1 (max.)	
Harmonic Distortion		≤ 1% THD (Linear Load), ≤ 4 % THD (Non-linear Load)	
Transfer Time	AC Mode to Batt. Mode	Zero	
	Inverter to Bypass	Zero	
Waveform (Batt. Mode)		Pure Sinewave	
Overload	AC Mode	100%~110%: 10min	110%~130%: 1min >130% : 1sec
	Battery Mode	100%~110%: 30sec	110%~130%: 10sec >130% : 1sec
EFFICIENCY			
AC Mode		94%	
ECO Mode		≥ 96% @ battery fully charged	
Battery Mode		91%	
BATTERY			
Standard Model	Battery Type	12 V / 7 AH	12 V / 9 AH
	Numbers	20	
	Typical Recharge Time	9 hours recover to 90% capacity	
	Charging Current (max.)	1.0 A	
	Charging Voltage	273 VDC ± 1%	
Long-run Model	Battery Type	Depending on applications	
	Numbers	16~20**	
	Charging Current (max.)	4.0 A	
	Charging Voltage	(13.65VDC x battery number) ± 1%	
INDICATORS			
LCD Panel		UPS status, Load level, Battery level, Input/Output voltage, Discharge timer, and Fault conditions	
ALARM			
Battery Mode		Sounding every 4 seconds	
Low Battery		Sounding every second	
Overload		Sounding twice every second	
Fault		Continuously sounding	
PHYSICAL			
Standard Model	Dimension, D x W x H (mm)	UPS Unit: 610x438x88 [2U] Battery Pack: 600x438x133 [3U]	UPS Unit: 610x438x88 [2U] Battery Pack: 600x438x133 [3U]
	Net Weight (kgs)	UPS Unit: 17 Battery Pack: 57	UPS Unit: 20 Battery Pack: 63
Long-run Model	Dimension, D x W x H (mm)	610 x 438 x 88 [2U]	
	Net Weight (kgs)	17	
		20	
ENVIRONMENT			
Operating Humidity		20~90 % RH @ 0~ 40°C (non-condensing)	
Noise Level		Less than 55dB @ 1 Meter	Less than 58dB @ 1 Meter
MANAGEMENT			
Smart RS-232 / USB		Supports Windows® 2000/2003/XP/Vista/2008, Windows® 7/8/10, Linux and MAC	
Optional SNMP		Power management from SNMP manager and web browser	
COMPLIANCE STANDARDS			
Safety		IEC/EN 62040-1	
EMC		IEC/EN 62040-2	
Performance		IEC/EN 62040-3	

* Derate capacity to 60% of capacity in CVCF mode, and to 90% when the output voltage is adjusted to 208VAC or parallel system is operated.

**When using 16 pieces of batteries, the output power factor will be derated to 0.8. If using 18 or 19 pieces of batteries, the output power factor will be derated to 0.9. If the UPS is installed or used in a place where the altitude is above 1000m, the output power must be derated one percent per 100m. Product specifications are subject to change without further notice.

Ver1.0_19.05.2021

Authorised Distributor/ Reseller:

Compatible with:



System Requirements:

Windows XP/Vista/7/8/10, Mac, Linux